



Clermont-Ferrand, France – February 24, 2020

## **MICHELIN AND AS 24 JOIN FORCES TO LAUNCH FLEET DIAG 24, A CONNECTED, SIMPLE-TO-USE OFFER DESIGNED TO FACILITATE TYRE DIAGNOSTICS AT SERVICE STATIONS**

Sustainable mobility sector leader Michelin and AS 24 – a subsidiary of Total, Europe's number one network of dedicated service stations for Heavy Trucks Vehicles, with 986 outlets in 28 countries – have joined forces to launch and experiment **Fleet Diag 24**, a new diagnostic offer designed to inspect truck tyres automatically at AS 24 service stations fitted with the device\*.

Marketed by AS 24, the service is conceived to facilitate and optimise tyre maintenance thanks to the automated inspection of pressures and wear to be sure that tyres function at their best – with no intervention required from either the driver or fleet service manager – in the interest of road safety and natural resource savings.

The chief benefits of **Fleet Diag 24** are:

- Safety and peace of mind,
- Compliance with legislation,
- Optimised tyre servicing,
- Enhanced fuel efficiency.

An integral feature of **Fleet Diag 24** is MICHELIN QuickScan, an efficient, easy-to-use, all-weather system designed to promote longer tyre life. Designed exclusively by Michelin to cover all types of rig (trucks, tractor units, trailers), irrespective of tyre brand, its development led to the filing of more than 15 patents.

### **MICHELIN QuickScan**

This reliable, unobtrusive tool incorporates the following functions:

- Automatic tyre-wear measurement whatever the weather (rain, snow, etc.), thanks to magnetic scanners.
- Tyre pressure measurement by means of a radio receiver coupled to the scanner (to be introduced in fall 2020).

The system comes in the form of a kit comprising:

- An RFID\*\* tag to be attached to the vehicle's chassis for identification purposes.
- Valve caps fixed to the wheel rims (available in fall 2020) to monitor tyre pressures.

In addition to this basic pack, a set of diagnostics tools is available for truck fleets, allowing reports conceived in collaboration with fleet managers (tire wear, underinflation identified, number of unseen vehicles...) and the recommendation of appropriate remedial action, if required, provided by Michelin experts (e.g. turn on rim, tire maintenance to be planned rapidly...).

This solution is an additional service proposed by AS 24 to its customers to expand its portfolio services dedicated to road transport professionals.

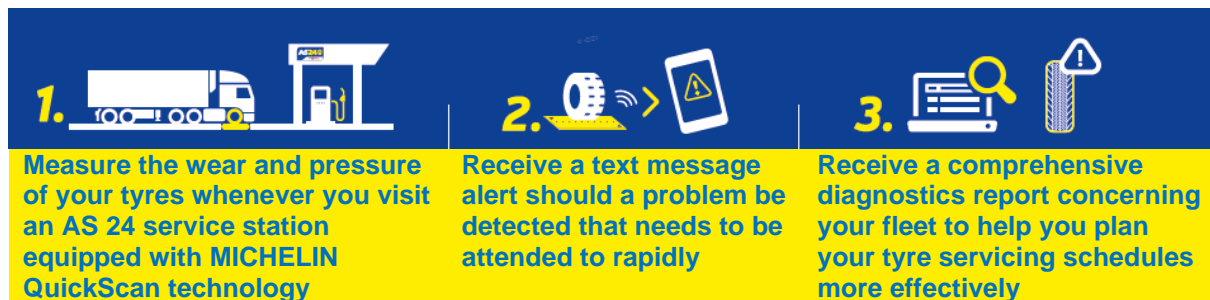

Pascal Zammit, Connected Mobility Director, Michelin: “This solution fits perfectly with Michelin’s All Sustainable vision to promote innovative connected solutions in favour of safe, more efficient mobility that is also more sustainable and respectful of the environment. Thanks to the extent of its network, our partnership with AS 24 is a tremendous opportunity for us to share our innovations with road haulage fleets.”

Manuel Olivier, President, AS 24: “AS 24 is delighted to be able to provide road transport professionals with Fleet Diag 24 in association with Michelin. This tyre diagnostics system enables our customers to make the very most of the time they spend in our service stations and enhance the safety of their fleets. Its launch is a further sign of AS 24’s resolve to facilitate the everyday lives of road transport professionals by means of accessible, user-friendly services and increasingly innovative solutions.”

For further information: [www.as24.com/fleetdiag24](http://www.as24.com/fleetdiag24)

#### Media contacts:

Michelin: +33 1 45 66 22 22 / [groupe-michelin.service-de-presse@michelin.com](mailto:groupe-michelin.service-de-presse@michelin.com)

AS 24: +33 2 40 92 24 24 / [as24-communication@as24.com](mailto:as24-communication@as24.com) / [www.as24.com](http://www.as24.com)

#### About Michelin:

*Michelin, the leading mobility company, is dedicated to enhancing its clients’ mobility, sustainably; designing and distributing the most suitable tyres, services and solutions for its clients’ needs; providing digital services, maps and guides to help enrich trips and travels and make them unique experiences; and developing high-technology materials that serve a variety of industries. Headquartered in Clermont-Ferrand, France, Michelin is present in 170 countries, has more than 127,000 employees and operates 69 tyre production facilities which together produced around 200 million tyres in 2019. ([www.michelin.com](http://www.michelin.com))*

#### About AS 24:

*Founded in 1988, AS 24 is a subsidiary of Groupe Total which specialises in the distribution of fuel and the provision of services for road haulage professionals. Thanks to a network of more than 980 service stations dedicated to trucks in 28 European countries and a payment scheme covering 18 countries, AS 24 stands out as a major player in the world of road transport mobility ([www.as24.com](http://www.as24.com)).*

\* Available from March 2020 in three service stations in France: Nantes Sud MIN (44), Clermont-Ferrand (63), Sainte-Marie-de-Cuines (73)

\*\* Radio Frequency Identification Device